

4 STOREY HOUSES WITH GABLE ROOF. RECTANGULAR FOUNDATION

Basic elements of the Districts series diorama, Part 15.
To build paper diorama with scissors and glue.

Options:

- several roof colors
- porch extensions
- pipe on the hip roof

For color printing: sheets 1-10

For black and white printing: sheets 11-18

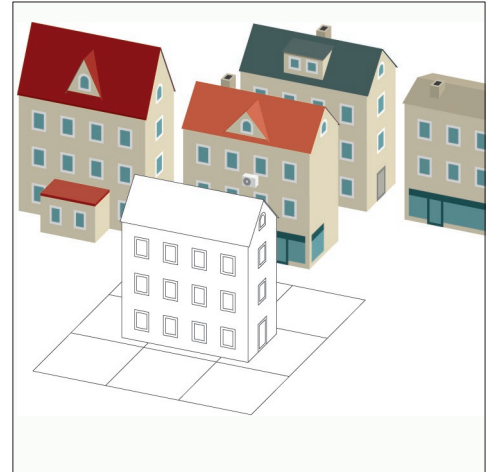

Assembly steps



1. Print the sheets on thick paper



2. Cut out each piece of a figure with scissors

Lorem ipsum



3. Cut out the inner holes with scissors
or with a ruler and a paper knife



4. Prepare the elements before assembling.
Mark the fold lines with a ruler and some blunt
instrument (e.g. a non-writing ball-point pen)



5. Pre-fold



6. Assemble with glue following the step by step
instructions below

Places for gluing are marked with icon 

Start assembling the element
from the place marked with the pink icon 